

STEEL SHIMS FOR MACHINE ALIGNMENT

PRE-CUT STEEL SHIMS

- Safer Work Place
- More Reliable
- Increased Accuracy
- Cost Savings
- Easier Stock Control

Advantages of Pre-Cut Shims

- Different pre-packed sizes
- Easily identify
- Flat, stability surface of the shim
- Burr free and rounded corner
- High quality stainless steel to prevent corrosion - using Austenitic stainless steel EN 10027-2-1,4310-5 (before DIN X9CrNi18 8) + 2H (shiny surface), 17249 cold rolled. Stiffness Rm 1200 - 1800 MPA



LOOSE SHIMS - 10pcs per pack

SIZE	Code	L mm	B mm	I mm	T mm	SIZE	Code	L mm	B mm	I mm	T mm
A	A-0.05	55	50	15	0.050 mm	B	B-0.05	75	70	23	0.050 mm
	A-0.10	55	50	15	0.100 mm		B-0.10	75	70	23	0.100 mm
	A-0.20	55	50	15	0.200 mm		B-0.20	75	70	23	0.200 mm
	A-0.50	55	50	15	0.500 mm		B-0.50	75	70	23	0.500 mm
	A-0.70	55	50	15	0.700 mm		B-0.70	75	70	23	0.700 mm
	A-1.00	55	50	15	1.00 mm		B-1.00	75	70	23	1.00 mm
	A-2.00	55	50	15	2.000 mm		B-2.00	75	70	23	2.000 mm
C	C-0.05	90	80	32	0.050 mm	D	D-0.05	125	105	44	0.050 mm
	C-0.10	90	80	32	0.100 mm		D-0.10	125	105	44	0.100 mm
	C-0.20	90	80	32	0.200 mm		D-0.20	125	105	44	0.200 mm
	C-0.50	90	80	32	0.500 mm		D-0.50	125	105	44	0.500 mm
	C-0.70	90	80	32	0.700 mm		D-0.70	125	105	44	0.700 mm
	C-1.00	90	80	32	1.00 mm		D-1.00	125	105	44	1.00 mm
	C-2.00	90	80	32	2.000 mm		D-2.00	125	105	44	2.000 mm

Shims Suite Case 6 x 20pcs Different Thickness x 3 Different Sizes = Total: 360pcs	A-0.05	B-0.05	C-0.05
	A-0.10	B-0.10	C-0.10
	A-0.20	B-0.20	C-0.20
	A-0.50	B-0.50	C-0.50
	A-0.70	B-0.70	C-0.70
	A-1.00	B-1.00	C-1.00
	Total: 120pcs	Total: 120pcs	Total: 120pcs

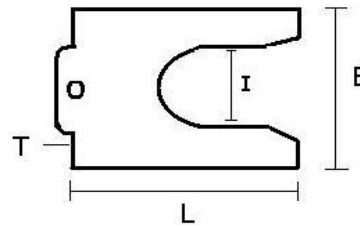

Shims Suite Case = 6 x 20pcs Different Thickness x 3 Different Sizes (A/B/C)